



★★★★
MADE IN THE
USA

PULSAR-3D SUCTION BLAST CABINET

SURFACE PREPS INDUSTRIAL PARTS AND FINISHES 3D-MANUFACTURED PARTS

IMPORTANT: For safe, efficient blasting, read and follow the operations manual and seek training for everyone who will use this equipment.



The Pulsar-3D surface preps and finishes small, delicate, and 3D-manufactured parts, as well as sturdier parts or those with complex geometries. It is easy to operate and maintain, uses and reclaims most common media, and fits into tight workspaces.

OVERVIEW

The Pulsar®-3D Suction Blast Cabinet surface preps small workpieces and production parts, leaving them with a consistent finish over their entire surface. It also reduces build lines and removes excess powders from 3D-manufactured prototypes and production parts. It easily switches between different media and fits into tight office and industrial workspaces.

ADVANTAGES

- Easy to operate and maintain.
- Compact, free-standing design.
- Safe for use in office and industrial environments.
- Uses most common 60-to-180 mesh

media, including glass bead and aluminum oxide. Can also use S-70 to S-230 steel shot. *Not for use with silica sand and other nonrecyclable media.

FEATURES

- 14ga steel construction.
- High-output, 50-watt LED light for excellent visibility.
- Flip-up, top-access door with laminated-safety-glass view window.
- Safety interlock stops blasting if door is opened.
- Height adjustable legs enable operators to work comfortably and improve their line of sight through the view window.
- Pressure gauge and pressure regulator monitor and adjust blast pressure for different finishes.
- Moisture separator removes condensed water from air supply.
- Adjustable, industrial-quality metering valve.
- Clear media hose allows visibility of media flow.

100 CFM CYCLONE RECLAIMER

- Continuously extracts dust and debris while returning properly sized, usable media to the blast system.
- Enhances visibility inside the cabinet.

100 CFM REVERSE-PULSE DUST COLLECTOR

- MERV 10 rated dust collector that improves visibility inside the cabinet.
- Each pulse of the filter cartridge dislodges dust, which then falls into a sealed 3.5-gallon drum. If the drum is lined with a disposable bag,

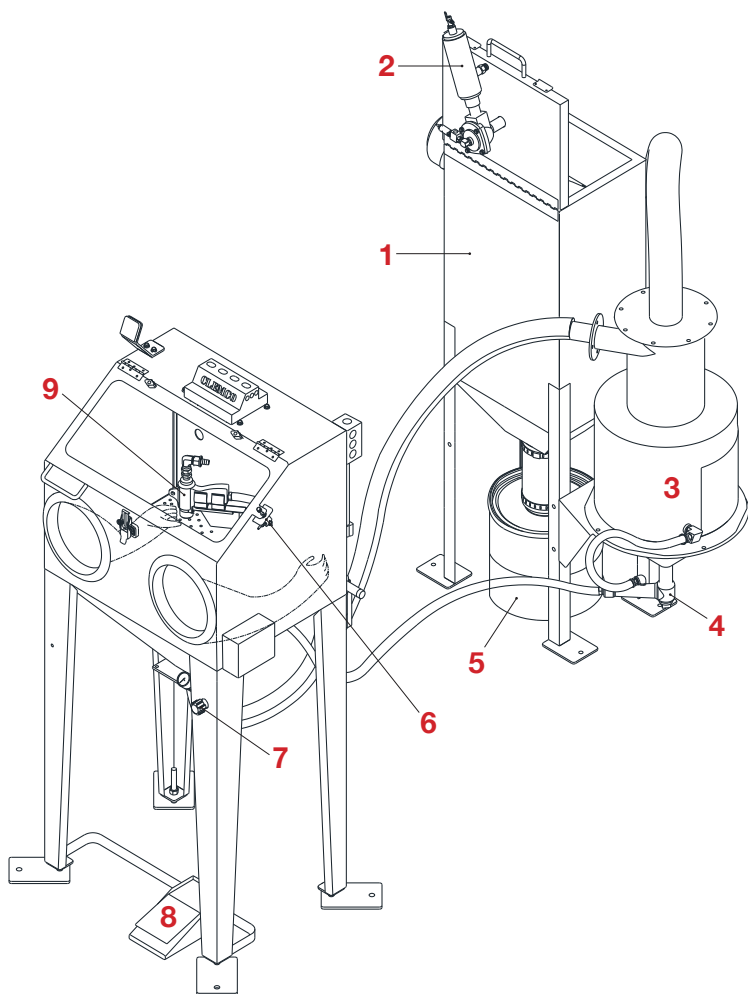

- operators never need to handle the dust.
- The compact (8" diam x 16" H), vertical, top-mounted cartridge can quickly be removed and replaced.

BNP® BLAST GUN

- Efficiently designed mixing chamber eliminates slugging and uneven media flow. Outperforms competitor blast guns.
- Foot-operated pedal.
- Fixed, interior mount is height and angle adjustable.
- Fixed mount enables operators to maneuver parts with both hands.
- Gun also can quickly be detached from the mount and then handheld for easier blasting of larger parts.
- Equipped with a 1/8" air jet and a 5/16" ceramic nozzle. (Air consumption is 21 CFM at 80 psi.)
- Can be fitted with a tungsten-carbide or boron-carbide nozzle for use with more aggressive media.
- Knurled nut at gun outlet allows operator to change nozzles without using tools.

SPECIFICATIONS

BNP Blast Gun: 1/8" air jet and a 5/16" ceramic nozzle

Air Consumption: 21 CFM at 80 psi

Electrical: 115V, 1 PH, 60 Hz

Amp Draw: 8

Cabinet Work Grating: 50 lb uniform load

Footprint of Complete Unit:
40.25" W x 47" D x 67.5" H

Work Chamber: 24" W x 18" D x 19" H

Viewing Area: 16.5" W x 8.5" H

Stock No. 29793

The **Pulsar-3D** can be used in numerous workplaces, including:

- | | |
|---|---|
| <p>Industrial</p> <ul style="list-style-type: none"> Additive manufacturing Aerospace Automotive Machine shops Medical devices/surgical tools Computer technology Pottery and glass production Jewelry production | <ul style="list-style-type: none"> Design teams Engineering firms IT research & production Medical research & development University research & development Art studios |
|---|---|

Diagram Key

- Dust collector
- Pulse reservoir
- Reclaimer
- Metering valve
- Waste drum
- Door interlock valve and actuator
- Pilot regulator (blast pressure)
- Foot pedal
- BNP® Blast Gun



ISO 9001 certified. Clemco is committed to continuous product improvement. Specifications are subject to change without notice.
©2019 Clemco Industries Corp. • One Cable Car Drive • Washington, MO 63090 • Phone: 636.239.4300 • Fax: 800.726.7559